

NVS-AC10006VC / NVS-AC10007VC
Volume Controller
User Manual

Thank you for using our NVS Product. Please read this User Manual carefully to make better use of this equipment



Attention

This equipment is not waterproof. To prevent fire or electric shock, please do not place any liquid filled containers (such as vases or flowerpots) near the equipment or expose the equipment to dripping, splashes, rain, or moisture.



Please hold the plug when moving the power cord. Do not pull the power cord when pulling out the power plug. Do not touch the power cord when your hands are on the device, please be sure to place it on a horizontal and stable surface.

Please keep this User Manual in good custody for future use.

Contents

Product Description.....	3
Features.....	3
Specification.....	3
Product Dimension.....	4
Connection Details.....	4
Installation Procedure.....	4

Product Description

NVS-AC10006VC/NVS-AC10007V volume controller is a high-power volume controller with 24V override function for audio conferencing system. It's compatible with NVS wall and ceiling speakers which have 100V line matching transformers and can be connected to a speaker or group of speakers with power rating up to 120 Watts. There are 5 volume selectable positions on the panel.

Features

- With override function, firefighting linkage.
- The power of the volume controller is 60W/120W.
- 5 gear volume adjustment.
- Elegant and compact design

Specifications

Model	NVS-AC10006VC	NVS-AC10007VC
Type	Five Gear Volume Control	
Rated Power	120W	60W
Override Signal	24V DC 10mA	
Gear Output (Input 1KHZ/100V, Load=82Ω, distortion degree<1%)	STEP : 0V (off) STEP1 : 13(±2) V STEP2 : 26(±2) V STEP3 : 51(±2) V STEP4: 100V	
Gear Freq. Response (normal operating conditions (-3DB))	STEP1 : 70Hz~18kHz STEP2 : 70Hz~18kHz STEP3 : 70Hz~18kHz	
Input DC24V override signal output (position switch can be placed at any location)	100V (Input 1KHZ/100V, Load=82Ω, distortion<1%)	

Product Dimension

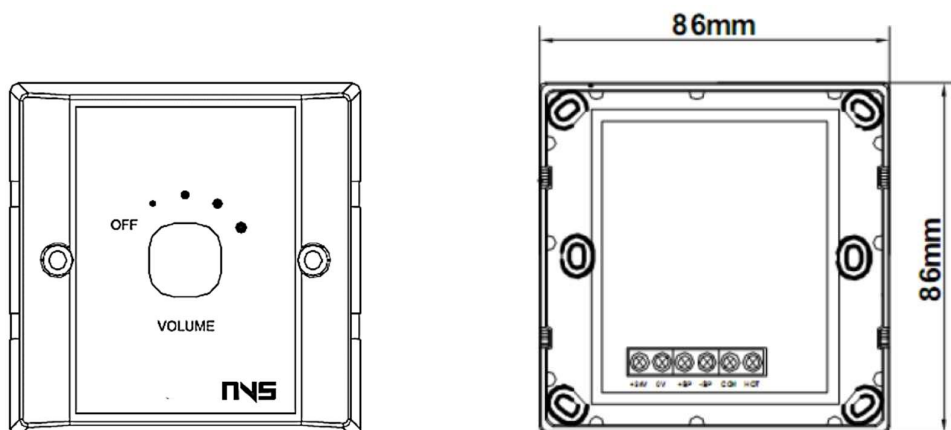

Connection Details

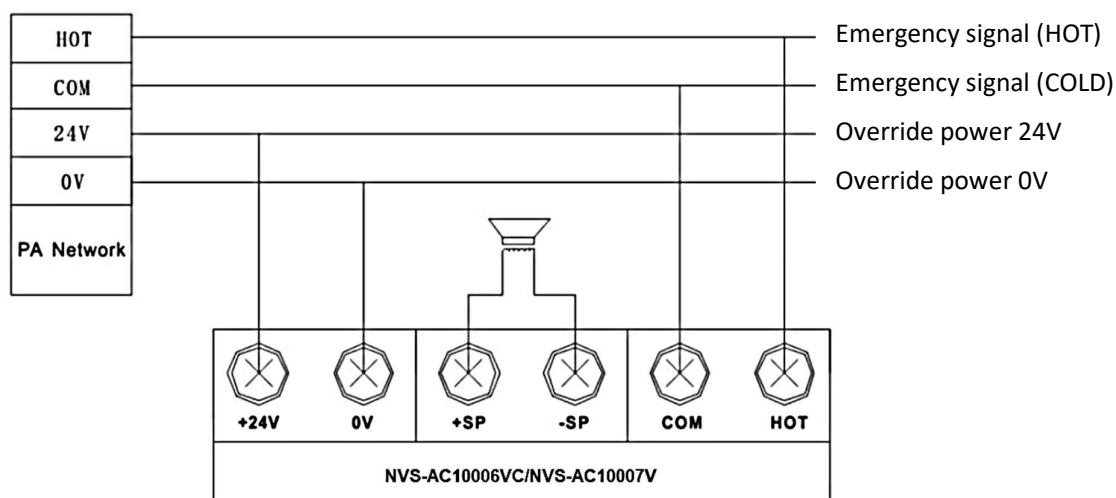

Installation Procedure

1. When installing, please ensure that the depth of the bottom box of the volume controller is more than 50mm, or the optional 86 sound control box is provided by our company.
2. The embedded leader (audio input line and speaker connector) is connected to the volume controller on the back of it.

3. The volume controller is closed to the installation bottom box, then fixed with screws.
4. Cover the volume controller (the panel alignment of the volume controller then presses hard) can be installed.

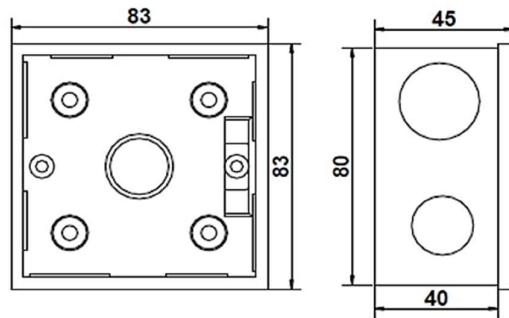

Mounting Box Dimension

Installation
box in the wall

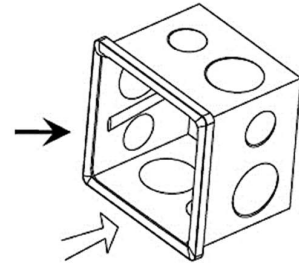

Installation Direction Diagram

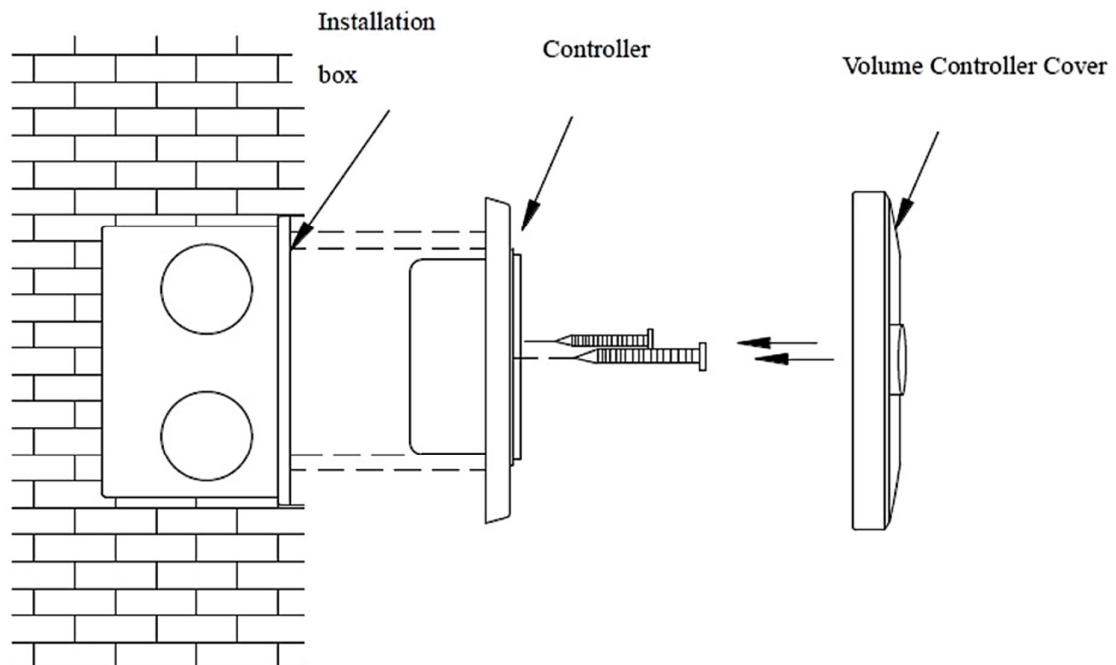

Note: Make sure the volume knob of the volume controller is tuned to the smallest gear before connecting the leader to the volume controller and ensure that the volume controller is installed and connected without charging all the machines.

CAUTION

- When the power switch is "OFF", the machine is not completely disconnected from the power grid. For the sake of safety, please pull the power cord plug out of the socket when not using the equipment.
- The equipment shall not be subject to water drops or splashes, and objects such as vases filled with water shall not be placed on the equipment.
- To reduce the risk of electric shock, do not remove the cover. If necessary, please ask professional personnel to repair.
- The symbol ⚡ on the rear panel indicates hazardous live. The connection of these terminals must be operated by the instructed person.
- The equipment is connected to the power grid through the power cord plug. In case of equipment failure or danger, the connection between the unit and the power grid can be disconnected by pulling out the power cord plug. Therefore, it is required to place the power socket to a position where the power cord can be plugged and unplugged conveniently.



Norden Communication UK Ltd.

Unit 13 Baker Close, Oakwood Business park, Clacton-On- Sea,
Essex CO15 4BD, United Kingdom
Tel +44 (0) 1255 474063 | E-mail: support@norden.co.uk